

The Covid-19 testing will take place every morning before joining the event at the venue.

Please remember to have your Covid-19 passport with you when attending the kick-off in person. To prevent the spread of the Covid-19 virus, please wear a mask during the event and remember to follow the recommended health guidelines and hand hygiene measures.

EXPRESS TESTS

For the safety of all attendees, we will provide one express test per participant/day of attendance.

- Each participant will need to take one express test per day
- On Monday, if you have the possibility, take a test before you arrive to the venue. If you can't, we will provide you with tests and ask you to take one on site.
- We will provide one test per day of attendance - on the other days, please take the test at your hotel before you come to the venue.

IN CASE OF A POSITIVE TEST

If the test is positive, you will need to take a PCR test (at your own expense) and follow the instructions given by the local authorities. One possible laboratory for PCR tests is next to the venue, LBM TURBIGO, 52 Rue de Turbigo, 75003 Paris, +33 (0)1 76 21 57 76.

HOW TO USE THE TEST

PREPARATION

- Clear, clean and dry a flat surface, where you can place the test.
- Check the test kit contents. Make sure that nothing is damaged or broken.
- Keep a timer at hand.
- Blow your nose several times before collecting specimen.
- Wash hands.

DISPOSAL

The test kit may be disposed of with normal household waste in accordance with the applicable local regulations.

HOW TO USE THE TEST - see next page!

USING THE TEST

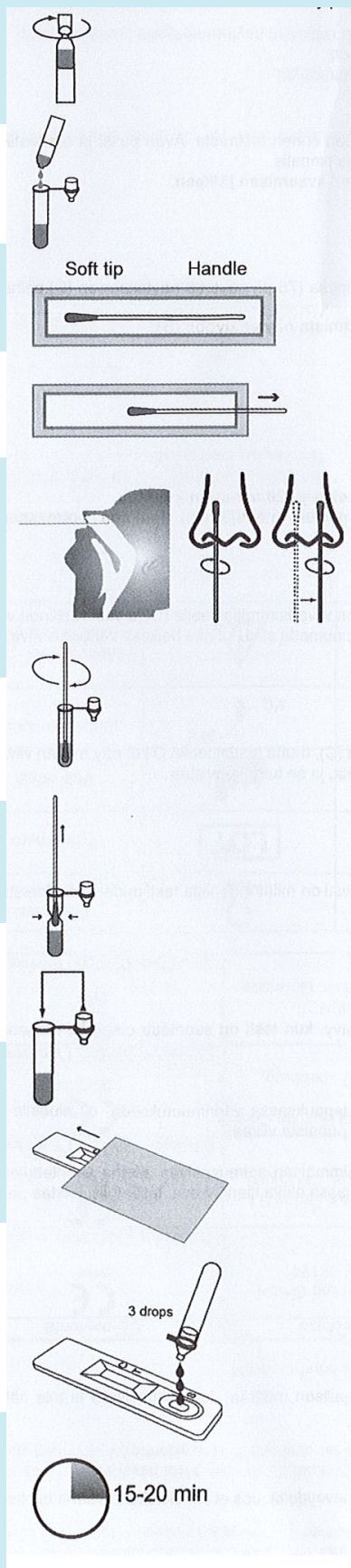

- 1 Rotate the lid of sample extraction buffer bottle.
Caution: *Open it away from your face and be careful not to spill any of the liquid.*
- 2 Squeeze all extraction buffer out of the bottle into the extraction tube. **Caution:** *Avoid the bottle touching the tube.*
- 3 Find the swab in the sealed wrapper. Identify the soft, fabric tip of the swab.
- 4 Peel open the swab packaging and gently take out the swab.
Caution: *Never touch the soft, fabric tip of the swab with your hands.*
- 5 Carefully insert swab into one nostril. The swab tip should be inserted to no less than 2,5 cm (1 inch) from the edge of the nostril. Roll swab 3-4 times along the mucos inside the nostril. Leave swab in the nostril for several seconds. Using the same swab, repeat the process for the other nostril. Withdraw swab from the nasal cavity.
Caution: *This may feel uncomfortable. Do not insert the swab any deeper if you feel strong resistance or pain.*
- 6 Place swab into extraction tube. Roll swab 3-5 times. Leave swab in extraction buffer for 1 minute.
- 7 Pinch extraction tube with fingers and remove the solution from swab as much as possible.
- 8 Install the nozzle cap onto the sample extraction tube tightly.
- 9 Bring the kit components to room temperature before testing. Open the pouch and remove the card. Place the card on a flat and level surface. **Caution:** *Once opened, the test card must be used immediately.*
- 10 Invert the extraction tube and add 3 drops of test specimen into the specimen well (S) by gently squeezing the extraction tube.
Caution: *The formation of air bubbles in the specimen well (S) must be avoided.*
- 11 Read the results within 15-20 minutes. The results can be interpreted according to the right hand model. >>
Caution: *The used device may be disposed of with normal household waste in accordance with the applicable local regulations.*



Positive



Negative

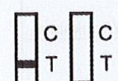

Invalid